



SPECIFICATION

- TAPE WIDTH: 1 1/2", 2"
- SPEED: 30 METERS/MINUTE
- ADJUSTABLE TAPE LEG: 45mm-55mm

OPTION

- TAPE WIDTH: 3"
(WHEN EQUIP WITH 3" TAPE HEAD, ADD 30MM TO MIN WIDTH)

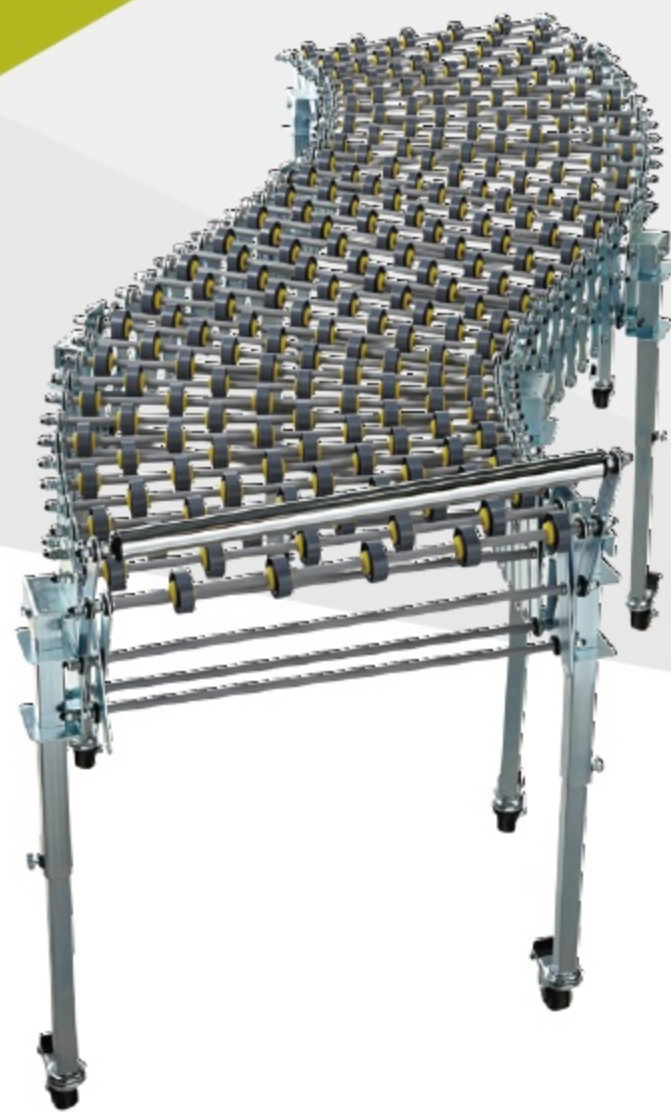
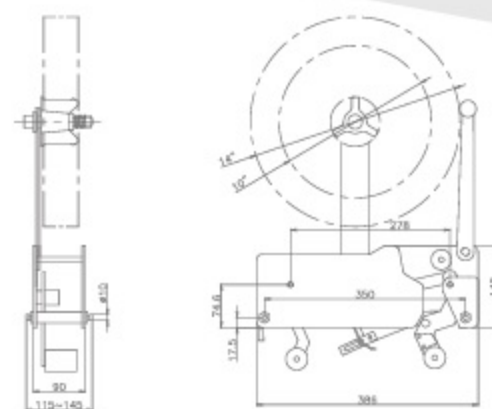

SPECIFICATION

- SKATE ROLLER TYPE
- WIDTH: 500MM
- LENGTH: 1500mm ~ 4500mm
- HEIGHT: 500mm ~ 800mm

EXC-SERIES

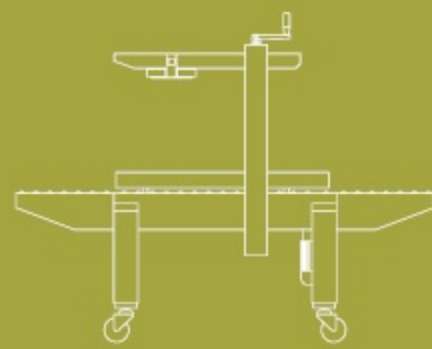

EXC-103SD



EXC-101

EXCSERIES

EXTEND THE PARTNERSHIP

EXTEND GREAT INTERNATIONAL CORP.

20F., NO. 309, Sec. 2, TAIWAN BLVD.,
TAICHUNG, TAIWAN, R.O.C.

T 886-4-2326-5568
F 886-4-2326-2268

www.extendgroup.com.tw
extend@extendgroup.com.tw

EXC-103SDS



SPECIFICATION

- TAPE WIDTH: 1 1/2", 2"
- BELT SPEED: 23 METERS/MINUTE
- CAPACITY: (L) 120mm-∞ (W) 110mm-500mm (H) 120mm-500mm
- POWER SUPPLY: 100/110/220/230/240V, 50Hz/60Hz, 1-Phase
- POWER CONSUMPTION: 450W

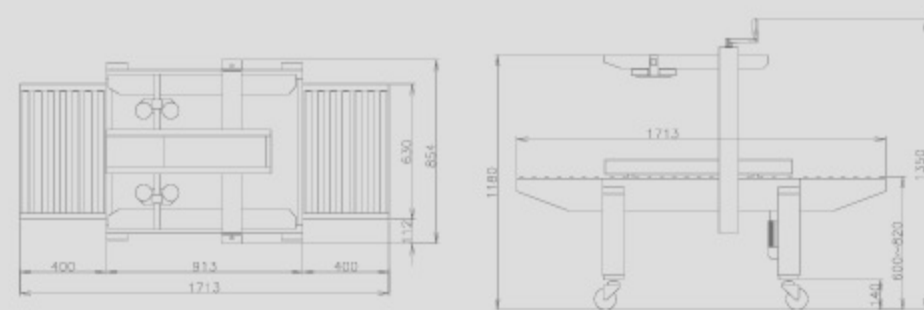

EXC-103SDT



SPECIFICATION

- TAPE WIDTH: 1 1/2", 2"
- BELT SPEED: 23 METERS/MINUTE
- CAPACITY: (L) 120mm-∞ (W) 180mm-500mm (H) 120mm-700mm
- POWER SUPPLY: 100/110/220/230/240V, 50Hz/60Hz, 1-Phase
- POWER CONSUMPTION 450W

OPTION

- 3" Tape Head
- 700MM(W)*700MM(H)

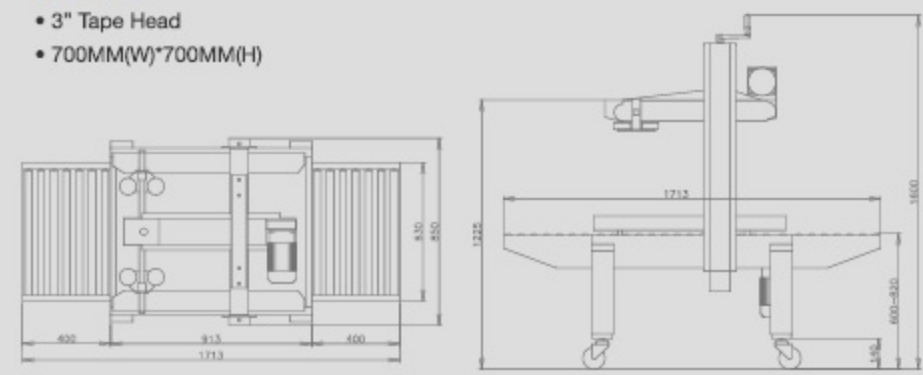

EXC-103SD



SPECIFICATION

- TAPE WIDTH: 1 1/2", 2"
- BELT SPEED: 23 METERS/MINUTE
- CAPACITY : (L) 120mm-∞ (W) 110mm-500mm (H) 120mm-500mm
- POWER SUPPLY: 100/110/220/230/240V, 50Hz/60Hz, 1-Phase
- POWER CONSUMPTION: 450W
- AVAILABLE WITH FLAP FOLDER MODEL EXC-103SDN

OPTION

- 3" Tape Head

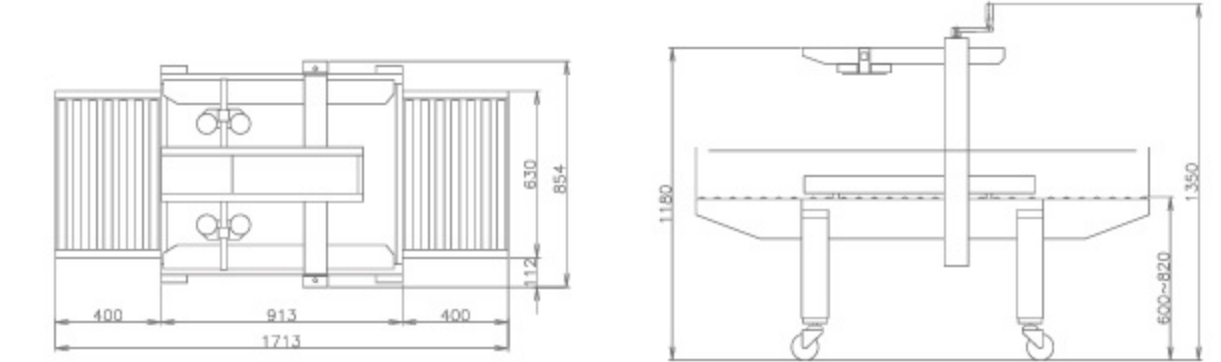

EXC-113SD



SPECIFICATION

- TAPE WIDTH: 1 1/2", 2"
- BELT SPEED: 23 METERS/MINUTE
- CAPACITY: (L) 120mm-∞ (W) 110mm-500mm (H) 120mm-500mm
- POWER SUPPLY: 100/110/220/230/240V, 50Hz/60Hz, 1-Phase
- POWER CONSUMPTION 450W

OPTION

- 3" Tape Head
- Dual Tape Heads

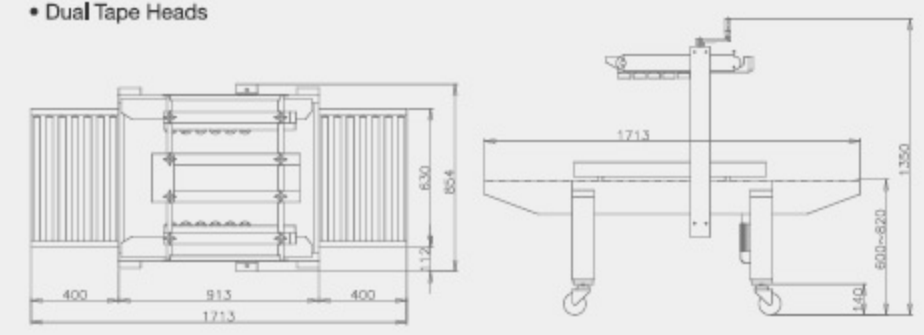

EXC-103TB



SPECIFICATION

- TAPE WIDTH: 1 1/2", 2"
- BELT SPEED: 23 METERS/MINUTE
- CAPACITY : (L) 120mm-∞ (W) 150mm-500mm (H) 120mm-500mm
- POWER SUPPLY: 100/110/220/230/240V, 50Hz/60Hz, 1-Phase
- POWER CONSUMPTION: 450W

OPTION

- 3" Tape Head

